



ROMILLY ROAD, LONDON, N4
£1,600,000 FREEHOLD

A CHARMING, FOUR BEDROOM FAMILY HOME SET MOMENTS FROM EXCELLENT SCHOOLS AND TRANSPORT LINKS.

Highbury | 0207 989 7000 | highbury@winkworth.co.uk



winkworth.co.uk

See things differently



DESCRIPTION:

A spacious, four bedroom, three reception room, two bathroom freehold home positioned on a handsome Victorian terrace moments from outstanding schools and transport links. Set across three floors, the property has tremendous charm sweeping through every level and would make an ideal setting for any growing family. Accommodation comprises of a wonderfully bright double reception room on the ground floor, leading through to a cleverly designed kitchen and dining area with the most delightful view out to a west facing, mature private garden. The first floor occupies a further reception room spanning the full width of the house, which could easily be a fifth bedroom, plus a good-sized double bedroom and sizeable family bathroom to the rear. The second floor presents an additional three bedrooms, all of which are doubles with the rear bedroom benefiting from a shower sweetly tucked away. The property is completed with a downstairs wc and the potential to extend further subject to planning permission.

Romilly Road is set in the popular 'Blackstock Triangle' known for its village atmosphere and tree lined streets. The property is located a short distance to a number of leading Islington schools and the Highbury Barn locale. For the outdoor enthusiast there are several sporting options nearby with Finsbury Park, Clissold Park and Highbury Fields offering wonderful spaces for recreation, and Gillespie Nature reserve and the Parkland walk for a leisurely stroll. Transport links are amongst some of the best in London with

Winkworth



Winkworth

Romilly Road, N4

Approx. Gross Internal Floor Area 1594 sq. ft / 148.16 sq. m

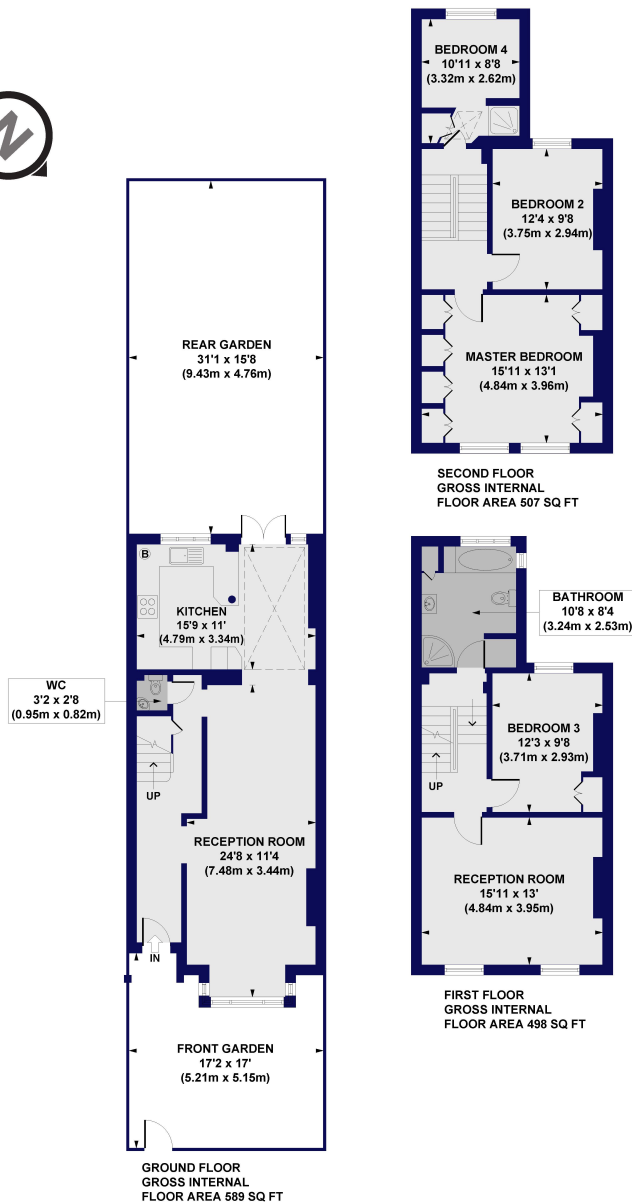

All measurements of walls, doors, windows, fittings and appliances, including their size and location, are shown as standard sizes and do not constitute any warranty or representation by the seller, their agent or CP Creative. Any intending purchaser must satisfy himself by inspection or otherwise as to the correctness of the information contained in these plans. This plan is for illustrative purposes only and should be used as such by any prospective purchasers.

Winkworth

This floorplan is for illustration purposes only and is not to scale. The position and size of doors, windows, appliances and other features are approximate.

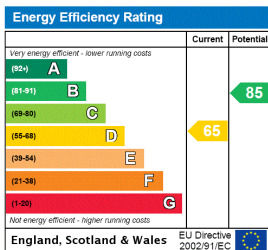

Highbury | 0207 989 7000 | highbury@winkworth.co.uk



winkworth.co.uk

See things differently

Winkworth wishes to inform prospective buyers and tenants that these particulars are a guide and act as information only. All our details are given in good faith and believed to be correct at the time of printing but they don't form part of an offer or contract. No Winkworth employee has authority to make or give any representation or warranty in relation to this property. All fixtures and fittings, whether fitted or not are deemed removable by the vendor unless stated otherwise and room sizes are measured between internal wall surfaces, including furnishings.