



MOORHOUSE ROAD, W2

£675,000 SHARE OF FREEHOLD (998 YEARS REMAINING)

A WONDERFUL FIRST FLOOR APARTMENT, WITH A LARGE SEPARATE STUDIO ROOM, SITUATED IN THE HEART OF ARTESIAN VILLAGE, NOTTING HILL.

1 Bedroom, 1 Reception Room, 1 Bathroom, Flat/Apartment, First Floor, Balcony, 465 Approx Sq Ft, Service charge £840 p/a, Ground Rent N/A

Winkworth

Notting Hill Sales | 0207 727 3227 | nottinghill@winkworth.co.uk

winkworth.co.uk

for every step...



DESCRIPTION:

This superb apartment is situated on the first floor of a most impressive period building on Moorhouse Road. The accommodation comprises a large open-plan reception room and kitchen with a balcony, double bedroom and bathroom. On the half landing between the ground and first floor is a large studio room with a window and plumbing which is demised to the flat.

LOCATION:

Moorhouse Road is a peaceful tree lined street running north from Artesian Road, just beyond the popular stretch of Westbourne Grove, with many of Notting Hill's most popular boutiques and restaurants moments away.

LOCAL AUTHORITY AND COUNCIL TAX BAND:

City of Westminster (Band D)



Moorhouse Road W2 5DJ

Approx Gross Internal Area = 36.6 sq m / 393 sq ft
 Half Landing Room = 6.7 sq m / 72 sq ft
 Total = 43.3 sq m / 465 sq ft

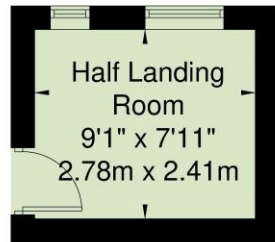
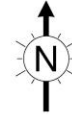

(Not Shown In Actual Location / Orientation)



First Floor

Ref

Copyright **BLEUPLAN**

The Floor plan is not to scale and measurements and areas shown are approximate and therefore should be used for illustrative purposes only. The plan has been prepared in accordance with the RICS code of Measuring Practice and whilst we have confidence in the information produced it must not be relied on. If there is any aspect of particular importance, you should carry out or commission your own inspection of the property.

Copyright @ BLEUPLAN

This floorplan is for illustration purposes only and is not to scale. The position and size of doors, windows, appliances and other features are approximate.

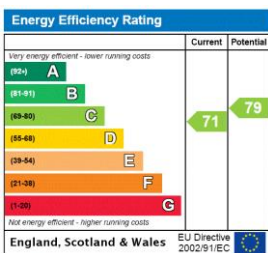

Notting Hill Sales | 0207 727 3227 | nottinghill@winkworth.co.uk



winkworth.co.uk

for every step...

winkworth wishes to inform prospective buyers and tenants that these particulars are a guide and act as information only. All our details are given in good faith and believed to be correct at the time of printing but they don't form part of an offer or contract. No Winkworth employee has authority to make or give any representation or warranty in relation to this property. All fixtures and fittings, whether fitted or not are deemed removable by the vendor unless stated otherwise and room sizes are measured between internal wall surfaces, including furnishings.