



HOLMBURY VIEW, LONDON, E5  
£539,000 LEASEHOLD

## A FANTASTIC THREE BEDROOM APARTMENT SITUATED ON THE FIRST FLOOR OF THIS CONVERTED VICTORIAN HOUSE

Hackney | 020 8986 4216 | [hackney@winkworth.co.uk](mailto:hackney@winkworth.co.uk)

**Winkworth**





## DESCRIPTION:

This delightful property offers a long lease and the perfect first time buy on a quiet residential street, it comprises of a light and spacious eat in kitchen, a well-proportioned reception room with a feature fire place, two genuine double bedrooms with high ceilings and floods of natural light, another smaller double bedroom and a contemporary bathroom suite.

Springfield Park is adjacent to the property, great for weekend and evening strolls, as well as the River Lee and the Lee valley nature reserve. This property further benefits from being centrally located equal distance between, Clapton, Stamford Hill and Stoke Newington. Close to local shopping and transport facilities.

**Winkworth**





**Winkworth**

# Holmbury View, E5

Approx. Gross Internal Floor Area 813 sq. ft / 75.51 sq. m

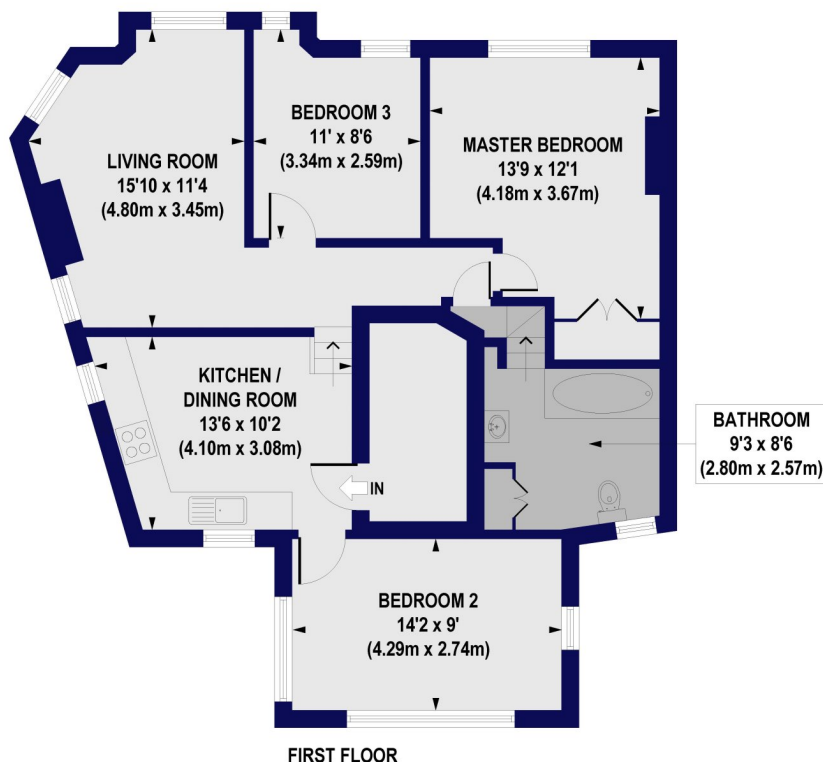

All measurements of walls, doors, windows, fittings and appliances, including their size and location, are shown as standard sizes and do not constitute any warranty or representation by the seller, their agent or CP Creative. Any intending purchaser must satisfy himself by inspection or otherwise as to the correctness of the information contained in these plans. This plan is for illustrative purposes only and should be used as such by any prospective purchasers.

**Winkworth**

This floorplan is for illustration purposes only and is not to scale. The position and size of doors, windows, appliances and other features are approximate.

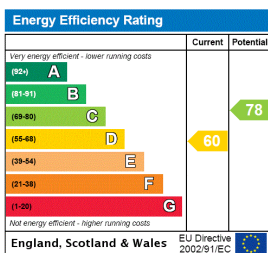

Hackney | 020 8986 4216 | [hackney@winkworth.co.uk](mailto:hackney@winkworth.co.uk)

**Winkworth**

[winkworth.co.uk](http://winkworth.co.uk)

See things differently

Winkworth wishes to inform prospective buyers and tenants that these particulars are a guide and act as information only. All our details are given in good faith and believed to be correct at the time of printing but they don't form part of an offer or contract. No Winkworth employee has authority to make or give any representation or warranty in relation to this property. All fixtures and fittings, whether fitted or not are deemed removable by the vendor unless stated otherwise and room sizes are measured between internal wall surfaces, including furnishings.