



LAINDON HOUSE, STAMFORD HILL, LONDON, N16  
**£475,000 LEASEHOLD**

# A RARELY AVAILABLE TWO BEDROOM FLAT JUST A MOMENTS WALK TO STAMFORD HILL STATION

Hackney | 020 8986 4216 | [hackney@winkworth.co.uk](mailto:hackney@winkworth.co.uk)







## DESCRIPTION:

An extremely well presented two-bedroom apartment on the second floor. This outstanding property has wooden floors and is neutrally decorated to a high standard throughout. It offers two double bedrooms, one with built in storage, a contemporary bathroom suite, a spacious reception & dining area and a separate modern kitchen

Stoke Newington and Stamford Hill is ideally situated in close proximity to the eclectic offerings of the ever-popular Stoke Newington Church Street. There are excellent transport links to The City and West End with numerous good bus routes and trains to Liverpool Street from Stoke Newington station (Overground).

**Winkworth**





Winkworth

# Stamford Hill, N16

## Second Floor

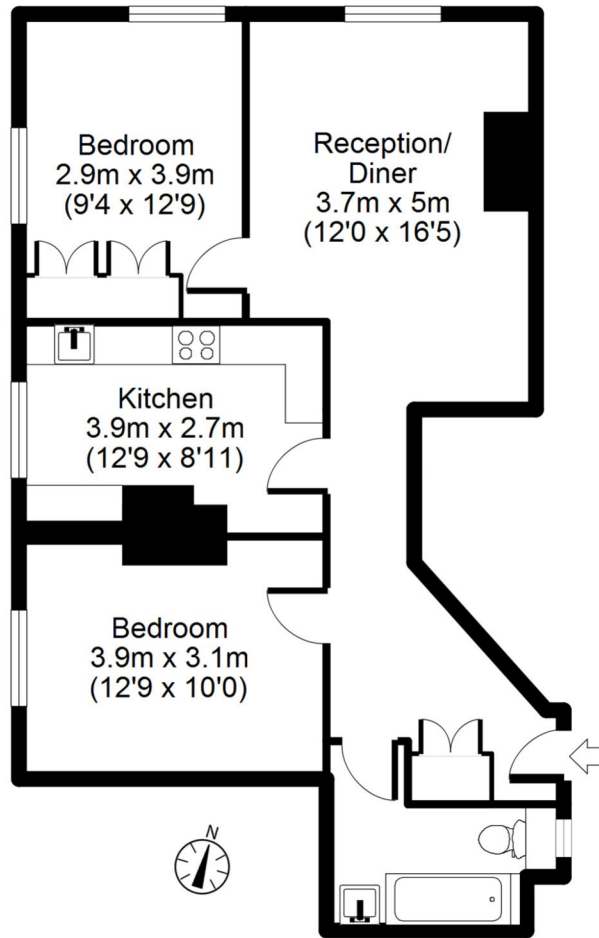

Total area: approx. 68.4 sq. metres (736 sq. feet)  
 For illustration purposes only - not to scale  
[www.lpaplus.co.uk](http://www.lpaplus.co.uk)

This floorplan is for illustration purposes only and is not to scale. The position and size of doors, windows, appliances and other features are approximate.

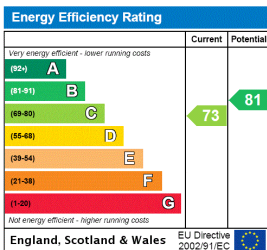

Hackney | 020 8986 4216 | [hackney@winkworth.co.uk](mailto:hackney@winkworth.co.uk)



[winkworth.co.uk](http://winkworth.co.uk)

See things differently

Winkworth wishes to inform prospective buyers and tenants that these particulars are a guide and act as information only. All our details are given in good faith and believed to be correct at the time of printing but they don't form part of an offer or contract. No Winkworth employee has authority to make or give any representation or warranty in relation to this property. All fixtures and fittings, whether fitted or not are deemed removable by the vendor unless stated otherwise and room sizes are measured between internal wall surfaces, including furnishings.