



WRENTHAM AVENUE, LONDON, NW10
£2,300,000 FREEHOLD

A SUPERB OPPORTUNITY TO OWN AND RENOVATE THIS BRILLIANT FIVE BEDROOM FAMILY HOME WITH A SOUTH FACING GARDEN ON WRENTHAM AVENUE, ONE OF THE MOST SOUGHT AFTER STREETS IN QUEENS PARK.

Kensal Rise & Queens Park | 0208 960 4947 | kensalrise@winkworth.co.uk

Winkworth



LOCATION:

Wrentham Avenue is one of the top destination streets in the area as houses are larger than average for around Queens Park. Transport links are good with the Bakerloo line less than a 1/2 mile away and the London Overground at Kensal Rise almost at the end of the street. Tiverton Park and Queens Park itself are very close by as are great local schools and amenities.



Winkworth

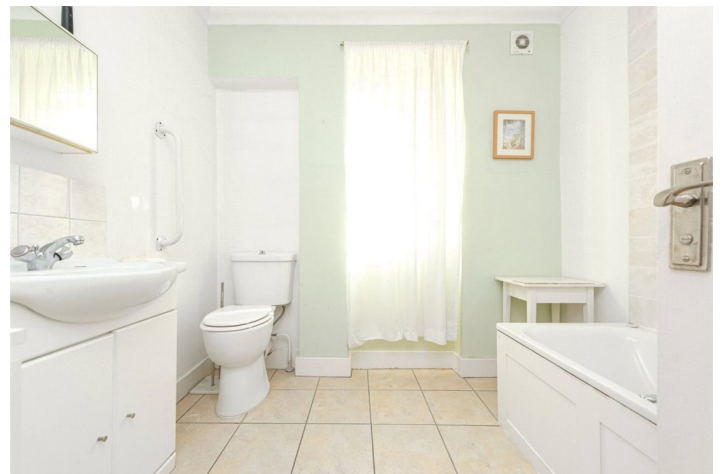

DESCRIPTION:

Families have been drawn to the immediate area and homes with a view of developing/extending. This property is spacious, currently offering 2124 sq.ft of internal space. The potential to extend is into the ground floor side return and into the loft space, which will create a stunning five/six bedroom home of approximately 3000+ sq.ft (all subject to planning and consents). The property further benefits from a 65ft long south garden and driveway/off street parking for two cars.

Winkworth

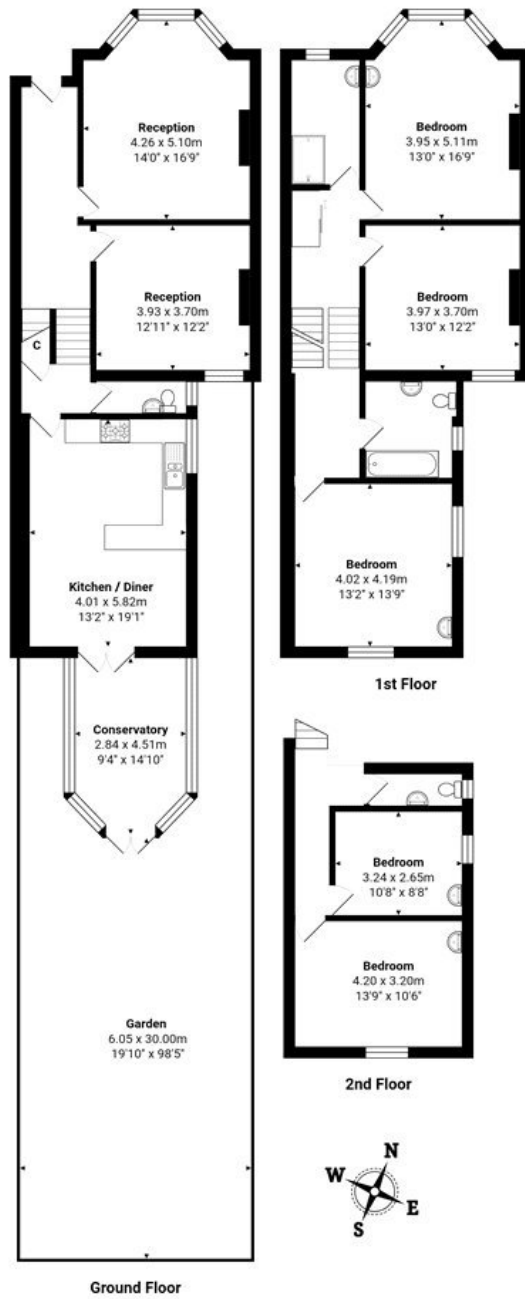

Total Area: 197.3 m² ... 2124 ft² (excluding garden)
 All measurements are approximate and for display purposes only

This floorplan is for illustration purposes only and is not to scale. The position and size of doors, windows, appliances and other features are approximate.

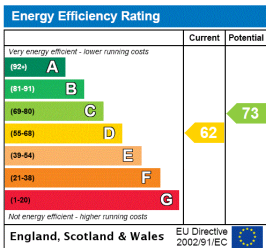

Kensal Rise & Queens Park | 0208 960 4947 | kensalrise@winkworth.co.uk



winkworth.co.uk

See things differently

winkworth wishes to inform prospective buyers and tenants that these particulars are a guide and act as information only. All our details are given in good faith and believed to be correct at the time of printing but they don't form part of an offer or contract. No winkworth employee has authority to make or give any representation or warranty in relation to this property. All fixtures and fittings, whether fitted or not are deemed removable by the vendor unless stated otherwise and room sizes are measured between internal wall surfaces, including furnishings.