



COTEFORD STREET, SW17
£600,000 FREEHOLD

A CHARMING TWO-BEDROOM MID-TERRACE HOUSE FOR SALE.

Tooting | 020 8767 5221 | tooting@winkworth.co.uk

Winkworth

for every step...

winkworth.co.uk



DESCRIPTION:

Winkworth Tooting is pleased to present this beautiful two-bedroom mid-terrace house for sale. The property has been recently renovated by the current owners to the highest standard, whilst retaining many of its original features and offers a fabulous balance of modern and period features throughout.

The house comprises a stunning open plan reception room with a feature fireplace and leads into the kitchen and dining area. The contemporary kitchen boasts integral appliances including an induction hob, dishwasher and washer/dryer and features large double french doors that open onto the rear south facing well-maintained garden.

On the first floor there are two well-proportioned bedrooms and a beautiful family bathroom. The master bedroom benefits from built in wardrobes and has access to the loft which allows for further storage space.

The house benefits from underfloor heating throughout, double glazed windows and has ample storage space. It will be offered to the market chain free, and it would make a fantastic first-time purchase.

Coteford Street is located in a sought-after location within easy walking distance to both Tooting Bec and Broadway tube stations as well as being within walking distance of the wide open spaces of Tooting Bec Common. Tooting Broadway and all local bus routes are close by, allowing easy access in and out of the city.



Coteford Street, SW17

Approx. Gross Internal Floor Area 559 sq. ft / 51.93 sq. m

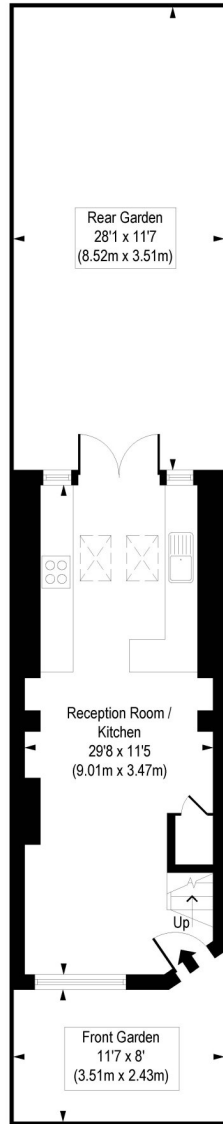

Ground Floor
Gross Internal
Floor Area 334 sq ft

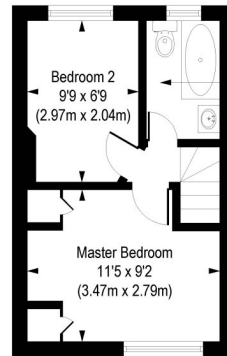

First Floor
Gross Internal
Floor Area 225 sq ft

COMPLIANT WITH RICS CODE OF MEASURING PRACTICE. Floorplan is for illustrative purposes only and is not to scale. Every attempt has been made to ensure the accuracy of the floorplan shown, however all measurements, fixtures, fittings and data shown are an approximate interpretation for illustrative purposes only. Liability for errors, omissions or mis-statement through negligence or otherwise is hereby excluded.

This floorplan is for illustration purposes only and is not to scale. The position and size of doors, windows, appliances and other features are approximate.

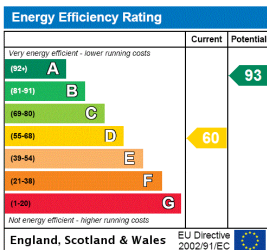

Tooting | 020 8767 5221 | tooting@winkworth.co.uk

for every step...

winkworth.co.uk

Winkworth wishes to inform prospective buyers and tenants that these particulars are a guide and act as information only. All our details are given in good faith and believed to be correct at the time of printing but they don't form part of an offer or contract. No Winkworth employee has authority to make or give any representation or warranty in relation to this property. All fixtures and fittings, whether fitted or not are deemed removable by the vendor unless stated otherwise and room sizes are measured between internal wall surfaces, including furnishings.