



CHAMBERLAYNE ROAD, LONDON, NW10  
**£550,000 LEASEHOLD**

**A LOVELY TWO BEDROOM FIRST FLOOR APARTMENT IN  
THIS GREAT LOCATION IN KENSAL RISE CLOSE TO  
QUEENS PARK.**

**Kensal & Queens Park** | 0208 960 4947 | [kensalrise@winkworth.co.uk](mailto:kensalrise@winkworth.co.uk)

**Winkworth**

*winkworth.co.uk*

See things differently



## LOCATION:

Chamberlayne Road has become one of the most popular streets in the area with it's array of shops, bars and restaurants at your fingertips. Transport links are good with the London Overground at Kensal Rise less than 100m from the house and the no. 52 bus stop opposite the house which can take you straight to Notting Hill in 10 mins. Furthermore Queens Park is just around the corner for those that like large green spaces.



**Winkworth**



**DESCRIPTION:**

This fantastic first floor apartment is in good condition throughout and is offered to the market with no upper chain. Accommodation comprises of two good sized double bedrooms, an eat in kitchen, bathroom and a large reception room to the front of the building. The property is larger than average measuring in at over 830 sq. ft.



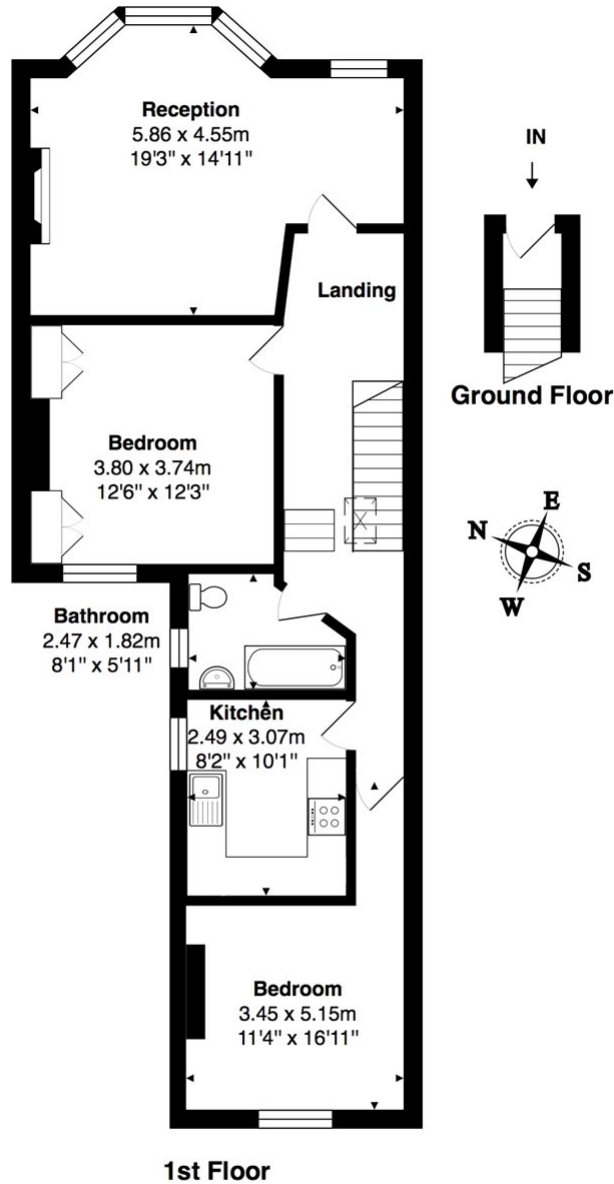

**1st Floor**

**Total Area: 77.5 m<sup>2</sup> ... 834 ft<sup>2</sup>**  
 All measurements are approximate and for display purposes only

This floorplan is for illustration purposes only and is not to scale. The position and size of doors, windows, appliances and other features are approximate.

Kensal & Queens Park | 0208 960 4947 | kensalrise@winkworth.co.uk



winkworth.co.uk

See things differently

winkworth wishes to inform prospective buyers and tenants that these particulars are a guide and act as information only. All our details are given in good faith and believed to be correct at the time of printing but they don't form part of an offer or contract. No winkworth employee has authority to make or give any representation or warranty in relation to this property. All fixtures and fittings, whether fitted or not are deemed removable by the vendor unless stated otherwise and room sizes are measured between internal wall surfaces, including furnishings.