



HIGHGATE, LONGMEAD TERRACE, BATH, BA2 £950PCM

Furnished studio apartment situated on the Bath Riverside development.

Bath | 01225 829 000 | bath@winkworth.co.uk

Tenant Fees Apply: Details of fees for tenant referencing, tenancy agreement admin fees and renewal fees are available on the Winkworth website and the link can be found with the displayed rent for the property. Tenants should ensure they are fully conversant with these upfront fees and other costs that are involved at the outset of the tenancy before making an offer to rent and your local Winkworth office will provide written details upon request.

winkworth.co.uk

Winkworth

for every step...



DESCRIPTION:

Winkworth are delighted to bring to the rental market, a modern, furnished, studio apartment situated within the Bath Riverside development.

The apartment has a light and airy feel with the open plan layout.

To offer flexible living, the studio has a vertical wall bed that can be kept out or alternatively folded away to create more living space.

Please note that there is no parking available.

Winkworth

for every step...



Winkworth

for every step...

Highgate, Longmead Terrace, Bath, Somerse
 Approximate Gross Internal Area
 342 Sq Ft/32 Sq M

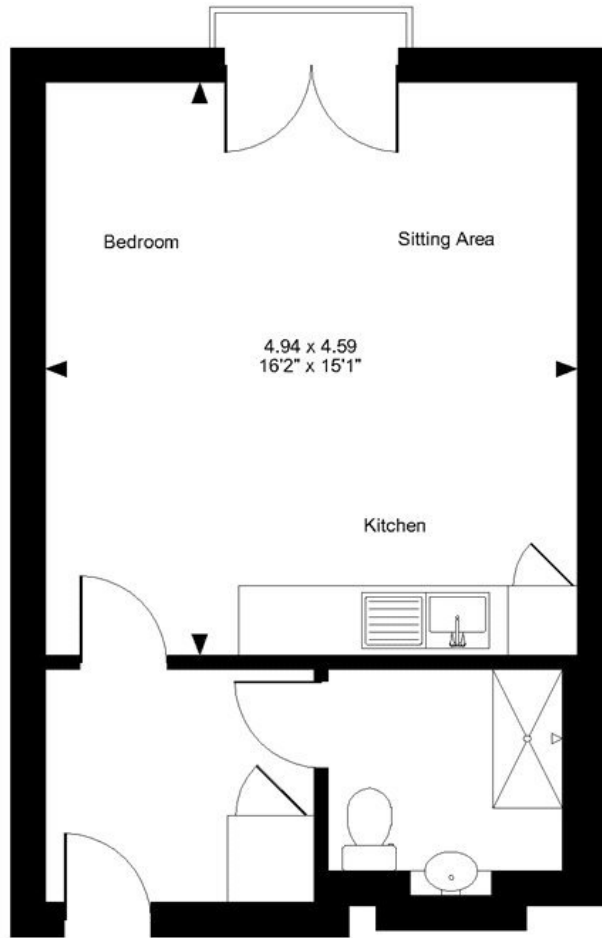
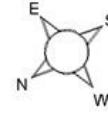

First Floor

FOR ILLUSTRATIVE PURPOSES ONLY - NOT TO SCALE
 The position & size of doors, windows, appliances and other features are approximate only.
 © ehouse. Unauthorised reproduction prohibited. Drawing ref. dig/8473383/DMS

This floorplan is for illustration purposes only and is not to scale. The position and size of doors, windows, appliances and other features are approximate.

Energy Efficiency Rating		Current	Potential
Very energy efficient - lower running costs	A (92+)		
B (81-91)	85	85	
C (69-80)			
D (55-68)			
E (39-54)			
F (21-38)			
Not energy efficient - higher running costs	G (1-20)		

England, Scotland & Wales EU Directive 2002/91/EC



Bath | 01225 829 000 | bath@winkworth.co.uk

for every step...

winkworth.co.uk

Winkworth wishes to inform prospective buyers and tenants that these particulars are a guide and act as information only. All our details are given in good faith and believed to be correct at the time of printing but they don't form part of an offer or contract. No Winkworth employee has authority to make or give any representation or warranty in relation to this property. All fixtures and fittings, whether fitted or not are deemed removable by the vendor unless stated otherwise and room sizes are measured between internal wall surfaces, including furnishings.