



MANOR WAY, HERTFORDSHIRE, WD6
£315,000 SHARE OF FREEHOLD

AN IMMACULATELY PRESENTED TWO DOUBLE BEDROOM SECOND FLOOR APARTMENT

Borehamwood | 020 8953 8899 | borehamwood@winkworth.co.uk



DESCRIPTION:

Offered for sale "Chain Free" and with an unexpired lease in excess of 900 years and the added benefit of a share of the freehold is this well presented two double bedroom, two bathroom second first apartment with lift and allocated parking.

The apartment has been meticulously maintained, is immaculately presented throughout and offers in excess of 700 Square feet of accommodation, the majority of which is Southerly facing and overlooking the communal gardens.

Located within easy access of Borehamwood High Street, with its plethora of shops and restaurants and Thameslink station, and also the newly constructed Sky studios the property would be ideal for a first time buyer, investor or downsizer.

AT A GLANCE

- 2 Bedrooms
- Share Of Freehold
- Allocated Parking Space
- Southerly Facing Balcony
- Two Bathrooms
- 720 Square Feet
- Lift
- Fitted Wardrobes





Winkworth



Winkworth

Approximate Gross Internal Area = 66.9 sq m / 720 sq ft

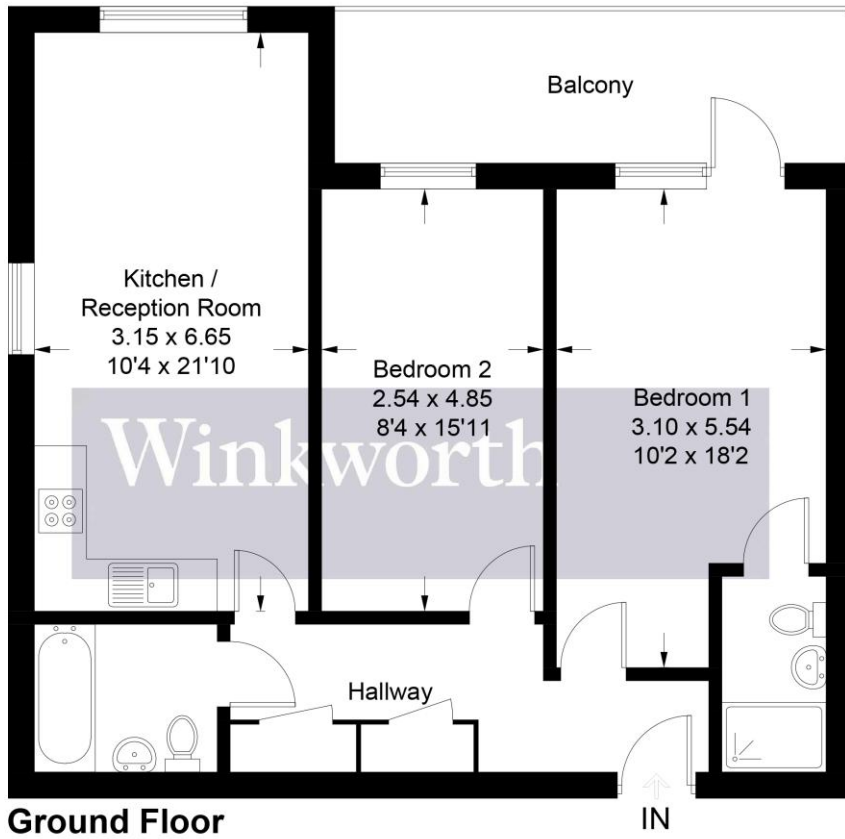

Illustration for identification purposes only, measurements are approximate, not to scale. Winkworth © 2024 (ID1047378)

This floorplan is for illustration purposes only and is not to scale. The position and size of doors, windows, appliances and other features are approximate.

Energy Efficiency Rating		
	Current	Potential
(92-100) A		
(81-91) B	88	88
(69-80) C		
(55-68) D		
(39-54) E		
(21-38) F		
(1-20) G		

Very energy efficient - lower running costs

Not energy efficient - higher running costs

England, Scotland & Wales EU Directive 2002/91/EC

Tenure: Share of Freehold
Term: Expires - 01/01/3017
Service Charge: £TBC per annum
Ground Rent: £ 0 Annually (subject to increase)
Council Tax Band:

Where no figures are shown, we have been unable to ascertain the information. All figures that are shown were correct at the time of printing.