



KINGSHILL DRIVE, MIDDLESEX, HA3
OFFERS IN EXCESS OF **£550,000** FREEHOLD

SPACIOUS FOUR BEDROOM FAMILY HOME

Tenure: Freehold
EPC Rating: D
Council Tax Band: E

Harrow | 020 8861 3933 | harrow@winkworth.co.uk

Winkworth

for every step...

winkworth.co.uk



DESCRIPTION:

Winkworth Harrow are delighted to bring to the Sales Market this Four bedroom Semi-Detached property.

The ground floor benefits from a reception room, open-plan kitchen/diner and a cloakroom. The first floor has 2 double bedrooms, a single room & family bathroom. The loft room is a double with an end-suite shower room. There is off street parking and potential to extend (STPP).

This family home is located on Kingshill Drive which falls within the catchment for some of the borough's leading schools and is within easy access to both Kenton and Harrow & Wealdstone Station, both offering quick and easy travel into Central London via the Bakerloo Line and National Rail Services.





GROUND FLOOR
443 sq.ft. (41.1 sq.m.) approx.

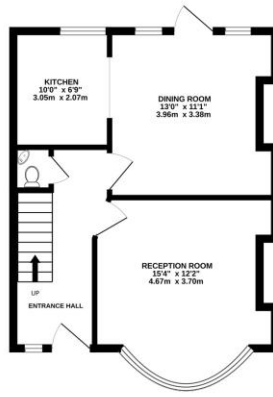

1ST FLOOR
442 sq.ft. (41.1 sq.m.) approx.

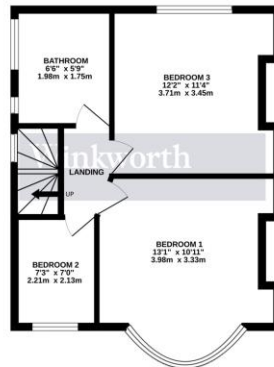

2ND FLOOR
285 sq.ft. (26.5 sq.m.) approx.

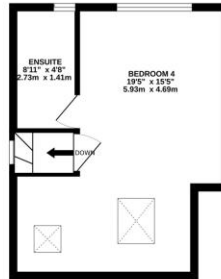

TOTAL FLOOR AREA : 1169 sq.ft. (108.6 sq.m.) approx.

Whilst every attempt has been made to ensure the accuracy of the floorplan contained here, measurements of doors, windows, rooms and any other items are approximate and no responsibility is taken for any error, omission or mis-statement. This plan is for illustrative purposes only and should be used as such by any prospective purchaser. The services, systems and appliances shown have not been tested and no guarantee as to their operability or efficiency can be given.
Made with Metropix ©2023

This floorplan is for illustration purposes only and is not to scale. The position and size of doors, windows, appliances and other features are approximate.

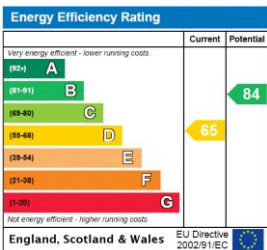

Harrow | 020 8861 3933 | harrow@winkworth.co.uk



for every step...

winkworth.co.uk

Winkworth wishes to inform prospective buyers and tenants that these particulars are a guide and act as information only. All our details are given in good faith and believed to be correct at the time of printing but they don't form part of an offer or contract. No Winkworth employee has authority to make or give any representation or warranty in relation to this property. All fixtures and fittings, whether fitted or not are deemed removable by the vendor unless stated otherwise and room sizes are measured between internal wall surfaces, including furnishings.