



BLANDFORD COURT, ST. PETER'S WAY, LONDON, N1
£395,000 LEASEHOLD

STUNNING 1 BEDROOM APARTMENT LOCATED MOMENTS FROM DE BEAUVOIR SQUARE

Highbury | 0207 989 7000 | highbury@winkworth.co.uk

Winkworth

winkworth.co.uk

See things differently



DESCRIPTION:

This beautifully renovated 1-bedroom apartment is located on the first floor of a small purpose-built development near De Beauvoir Square's green spaces. It features thoughtful design, maximizing space and light, with modern, high-quality finishes. Highlights include a new kitchen and bathroom, updated electricals, lighting throughout, and designer radiators in every room. Flooring is new throughout, with herringbone wood in the hallway, living room, and bedroom, oak wood in the study/utility room, quartz stone tiles in the kitchen, and Italian concrete effect porcelain tiles in the bathroom. The apartment also boasts a new Combi boiler, freshly painted rooms in Farrow & Ball, a new solid wood front door, and new internal doors, also painted in Farrow & Ball

Blandford Court is ideally positioned on the edge of De Beauvoir and Dalston, offering easy access to Haggerston, Dalston/Kingsland, and Dalston Junction stations on the London Overground, as well as Stoke Newington Church Street. The area is rich with a variety of shops, bars, and restaurants, including being a short distance from the well-known De Beauvoir Deli. Convenient bus routes are available on Kingsland Road, Southgate Road, and Essex Road. The lively neighborhoods of Hoxton and Shoreditch, along with National Rail services at Angel Islington and Victoria Line connections at Highbury & Islington, are all within a short distance.

Winkworth



Winkworth

Blandford Court, St. Peter's Way, N1
 Approx. Gross Internal Floor Area 513 sq. ft / 47.63 sq. m

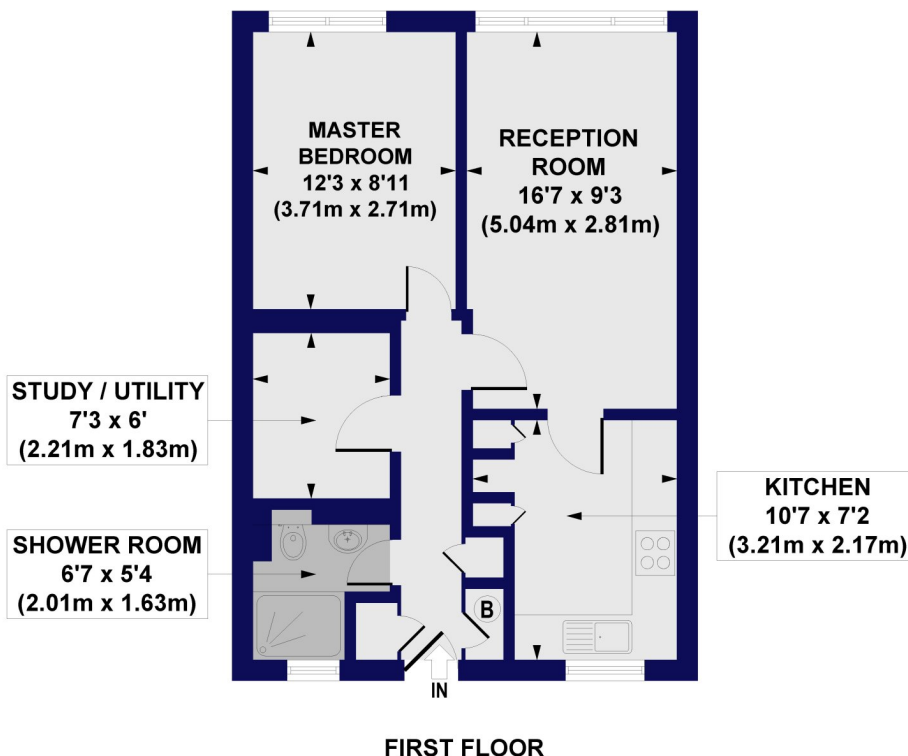

All measurements of walls, doors, windows, fittings and appliances, including their size and location, are shown as standard sizes and do not constitute any warranty or representation by the seller, their agent or CP Creative. Any intending purchaser must satisfy himself by inspection or otherwise as to the correctness of the information contained in these plans. This plan is for illustrative purposes only and should be used as such by any prospective purchasers.

Winkworth

This floorplan is for illustration purposes only and is not to scale. The position and size of doors, windows, appliances and other features are approximate.

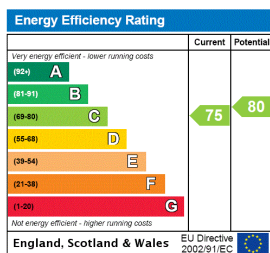

Highbury | 0207 989 7000 | highbury@winkworth.co.uk



winkworth.co.uk

See things differently

Winkworth wishes to inform prospective buyers and tenants that these particulars are a guide and act as information only. All our details are given in good faith and believed to be correct at the time of printing but they don't form part of an offer or contract. No Winkworth employee has authority to make or give any representation or warranty in relation to this property. All fixtures and fittings, whether fitted or not are deemed removable by the vendor unless stated otherwise and room sizes are measured between internal wall surfaces, including furnishings.