



VILLIERS ROAD, LONDON, NW2

£725,000 FREEHOLD

**THREE BEDROOM, MID-TERRACE VICTORIAN FAMILY HOME,
BENEFITTING FROM FOR A NEW OWNER TO ADD THEIR OWN
STAMP TO AND POTENTIAL TO EXTEND (STPP).**

Kensal Rise & Queens Park | 0208 960 4947 | kensalrise@winkworth.co.uk

Winkworth



LOCATION:

Located a short walk away to an array of amenities Willesden Green and Walm Lane have to offer, with excellent transport links at both Willesden Green & Dollis Hill Tube Stations (Jubilee Line, Zone 2). For recreation, Gladstone Park offers an array of facilities.



Winkworth



DESCRIPTION:

This well presented three bedroom family home, offers a great opportunity. With the ability to extend on the ground floor and in to the loft space, there is scope to transform the space by adding significant square-footage STPP. The property currently comprises of a separate front facing reception, additional reception room and kitchen to the rear, providing direct access on to the garden. The first floor has three double bedrooms and main bathroom. The property is coming to market with no-upper chain.



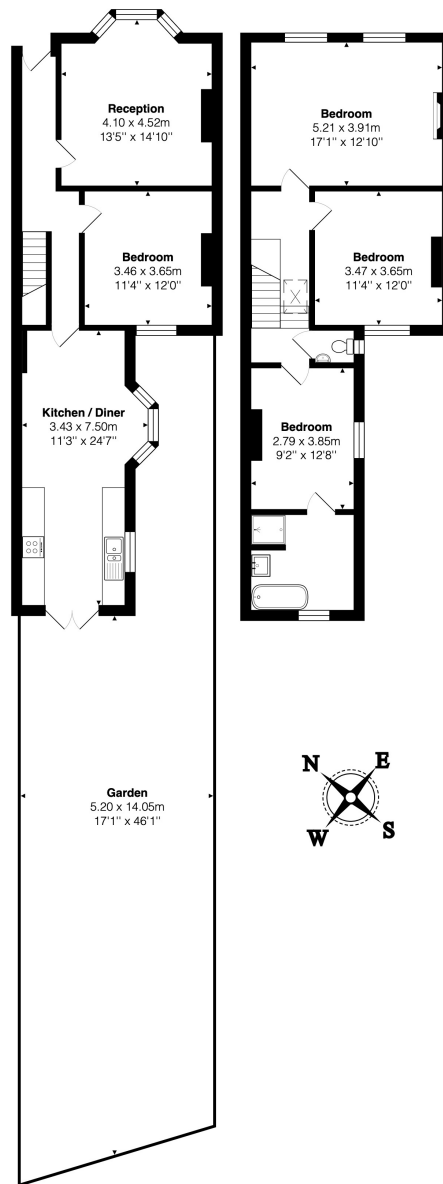

Total Area: 124.8 m² ... 1343 ft² (excluding garden)
All measurements are approximate and for display purposes only

This floorplan is for illustration purposes only and is not to scale. The position and size of doors, windows, appliances and other features are approximate.

Kensal Rise & Queens Park | 0208 960 4947 | kensalrise@winkworth.co.uk

Winkworth

winkworth.co.uk

See things differently

winkworth wishes to inform prospective buyers and tenants that these particulars are a guide and act as information only. All our details are given in good faith and believed to be correct at the time of printing but they don't form part of an offer or contract. No winkworth employee has authority to make or give any representation or warranty in relation to this property. All fixtures and fittings, whether fitted or not are deemed removable by the vendor unless stated otherwise and room sizes are measured between internal wall surfaces, including furnishings.