



PAGET STREET, LONDON, EC1V

**£725,000 LEASEHOLD APPROX. 91 YEARS REMAINING**

**A NICELY CONFIGURED TWO BEDROOM LATERAL CONVERSION  
ACROSS THE GROUND FLOORS OF TWO GEORGIAN STYLE  
TOWNHOUSES SET IN A CHARMING CLERKENWELL BACK STREET.**

Clerkenwell & City | 020 7405 1288 | [clerkenwell@winkworth.co.uk](mailto:clerkenwell@winkworth.co.uk)

**Winkworth**

for every step...

[winkworth.co.uk](http://winkworth.co.uk)





**DESCRIPTION:**

There is a large pretty communal patio garden with a section naturally associated with the flat. Paget Street is within a short walk from all the amenities of Upper Street and trendy hot spots such as Exmouth Market are close by. Angel, Barbican, Old Street, Farringdon and Kings Cross Stations are all easily accessed.



**Winkworth**

for every step...





**Winkworth**

for every step...

Paget Street, EC1V

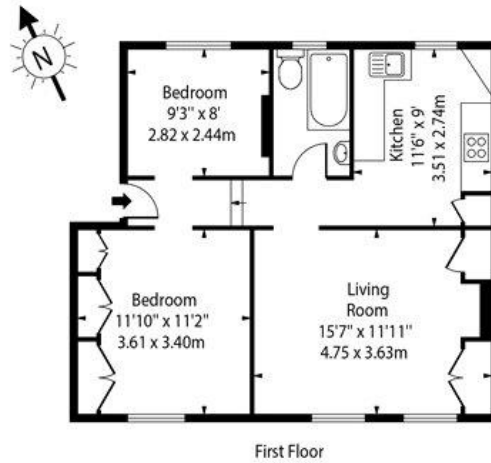

Approx Gross Internal Area 645 Sq Ft - 59.92 Sq M

This floor plan should be used as a general outline for guidance only and does not constitute in whole or in part an offer or contract. Any intending purchaser or lessee should satisfy themselves by inspection, searches, enquiries and full survey as to the correctness of each statement. Any areas, measurements or distances quoted are approximate and should not be used to value a property or be the basis of any sale or let.

This floorplan is for illustration purposes only and is not to scale. The position and size of doors, windows, appliances and other features are approximate.

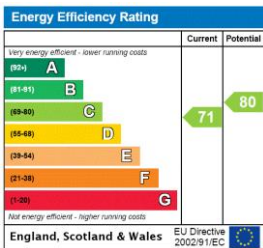

- Tenure:** Leasehold
- Term:** Expires - 21/03/2115
- Service Charge:** Approx. £1,130 per annum
- Ground Rent:** Approx. £10 Annually (subject to increase)
- Council Tax Band:** Islington D

Where no figures are shown, we have been unable to ascertain the information. All figures that are shown were correct at the time of printing.



Clerkenwell & City | 020 7405 1288 | clerkenwell@winkworth.co.uk

for every step...

winkworth.co.uk

Winkworth wishes to inform prospective buyers and tenants that these particulars are a guide and act as information only. All our details are given in good faith and believed to be correct at the time of printing but they don't form part of an offer or contract. No Winkworth employee has authority to make or give any representation or warranty in relation to this property. All fixtures and fittings, whether fitted or not are deemed removable by the vendor unless stated otherwise and room sizes are measured between internal wall surfaces, including furnishings.