



ROE LANE, LONDON, NW9
£360,000 LEASEHOLD

2 BEDROOM GROUND FLOOR MAISONETTE- BLANK CANVAS

Kingsbury | 020 8204 0000 | kingsbury@winkworth.co.uk

Winkworth

for every step...

winkworth.co.uk



DESCRIPTION:

Winkworth is delighted to bring to you this CHARMING GROUND FLOOR maisonette offering a perfect BLANK CANVAS for FIRST TIME BUYERS, SAVVY INVESTORS OR DOWNSIZERS. Boasting two spacious DOUBLE BEDROOMS, it provides ample room for comfortable living. Nestled in a conservation area, this home combines PERIOD CHARM WITH MODERN POSSIBILITIES. One of its standout features is the LUSH 100ft green garden, a serene oasis for relaxation and outdoor enjoyment. The purpose-built property's well-maintained structure ensures lasting quality and peace of mind for its occupants.

With the potential to be customized to your tastes, this maisonette is a promising investment opportunity. Don't miss the chance to shape this property into your ideal home or a profitable buy-to-let venture.

An internal viewing is highly recommended.



Winkworth

for every step...



Winkworth

for every step...

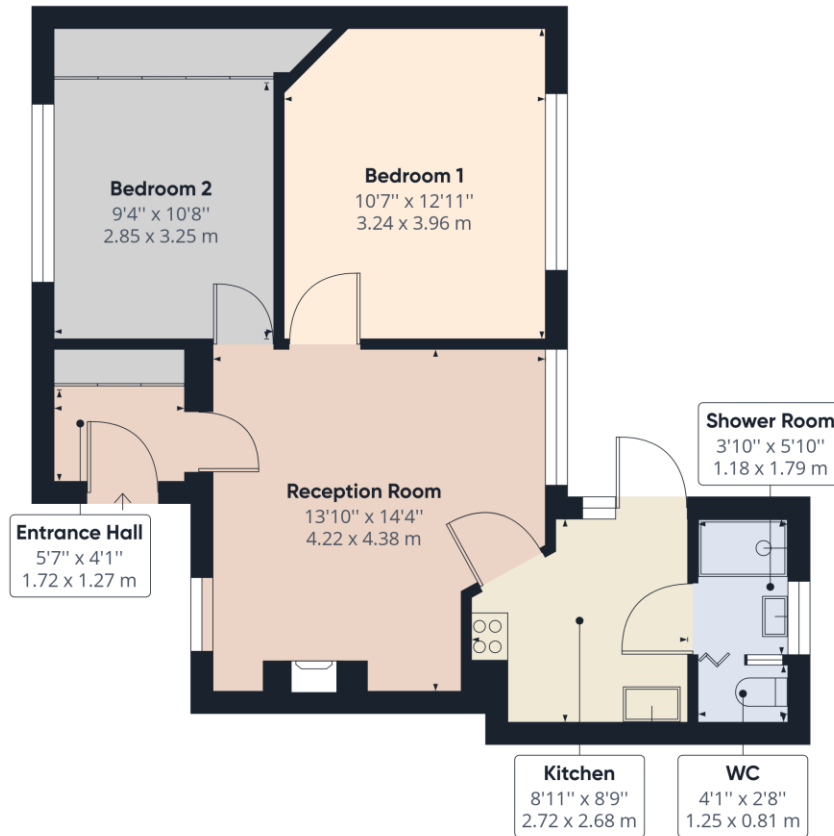

Approximate total area⁽¹⁾
576.52 ft²
53.56 m²

(1) Excluding balconies and terraces

While every attempt has been made to ensure accuracy, all measurements are approximate, not to scale. This floor plan is for illustrative purposes only.

GIRAFFE360

This floorplan is for illustration purposes only and is not to scale. The position and size of doors, windows, appliances and other features are approximate.