

LONG LANE, FINCHLEY, LONDON, N3
£600,000 FREEHOLD

A THREE BEDROOM MID TERRACED PERIOD STYLE FAMILY HOME

Finchley | 020 8349 3388 | finchley@winkworth.co.uk



DESCRIPTION:

We are pleased to offer this three bedroom period style family home, situated within walking distance to Victoria Park and all the transport and shopping facilities on Ballards Lane, as well as being in the catchment area for Outstanding Ofsted Rated Primary Schools. The property comprises of a spacious through-lounge, fitted kitchen, utility area, downstairs bathroom, three bedrooms, access to loft for storage and rear garden of circa 80ft. Further benefits include off street parking and potential to extend (stpp). An internal viewing is highly recommended!

AT A GLANCE

- Mid terraced house
- Through-lounge
- Kitchen/utility room
- Downstairs bathroom
- Three bedrooms
- Off street parking

COUNCIL TAX: Band E





Winkworth



Winkworth



Winkworth



Winkworth



Winkworth

Long Lane, N3

Approx. Gross Internal Floor Area 881 sq. ft / 81.91 sq. m

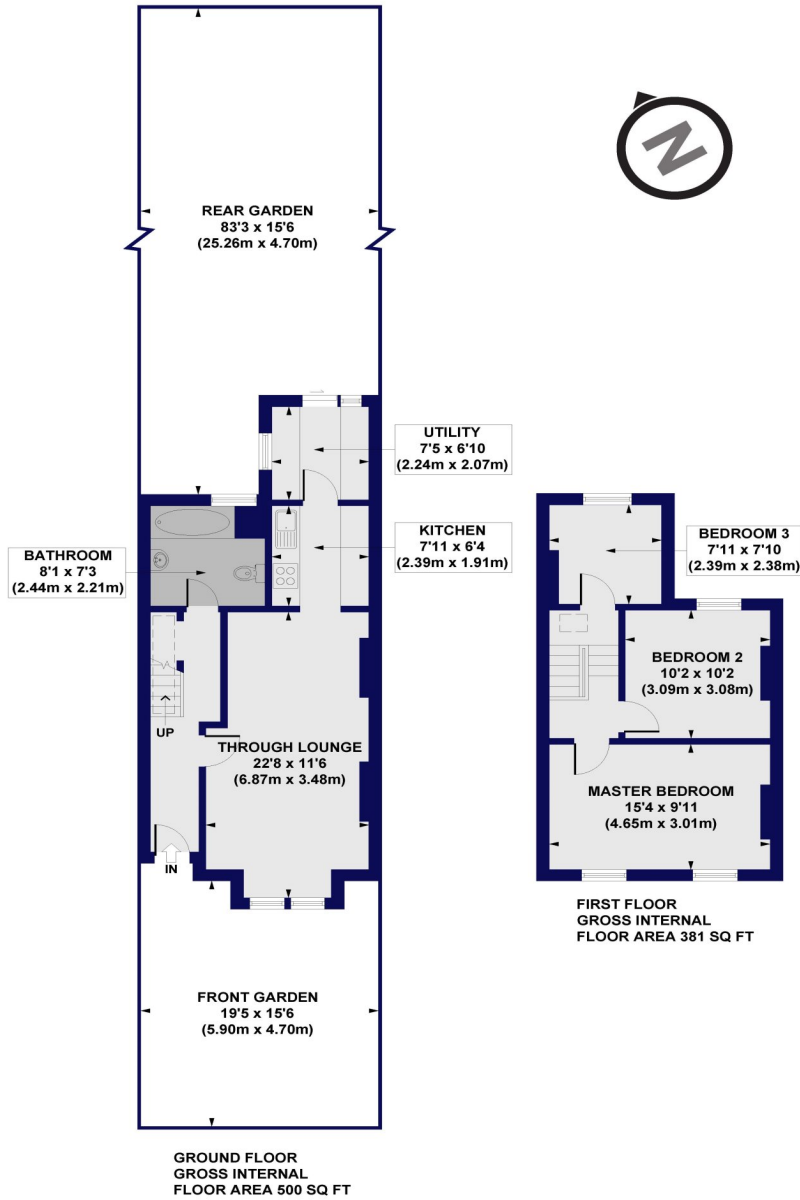

All measurements of walls, doors, windows, fittings and appliances, including their size and location, are shown as standard sizes and do not constitute any warranty or representation by the seller, their agent or CP Creative. Any intending purchaser must satisfy himself by inspection or otherwise as to the correctness of the information contained in these plans. This plan is for illustrative purposes only and should be used as such by any prospective purchasers.

Winkworth

