



KIMBOLTON GREEN, HERTFORDSHIRE, WD6
£400,000 FREEHOLD

A CHAIN FREE TWO BEDROOM SEMI DETACHED HOUSE IN SOUTH BOREHAMWOOD

Borehamwood | 020 8953 8899 | borehamwood@winkworth.co.uk



DESCRIPTION:

Located in a sought after turning on the highly desirable South side of Borehamwood, close to several "Good" and "Outstanding" Ofsted rated schools, including Monksmead, Summerswood and Yavneh is this two bedroom semi-detached family house.

In need of some updating, the property is offered for sale chain free and provides scope for extension subject to the usual planning consents.

Bus routes including the 292 and 107 with their services via Borehamwood Thameslink station to Edgware and Barnet respectively are located nearby.

AT A GLANCE

- 2 Bedrooms
- Chain Free
- South Borehamwood
- Off Street Parking
- Gas Central Heating
- Double Glazed
- Cul de Sac Location
- Scope To Extend (Stpp)





33 Kimbolton Green, WD6 2ND

Approximate Gross Internal Area = 68.9 sq m / 742 sq ft

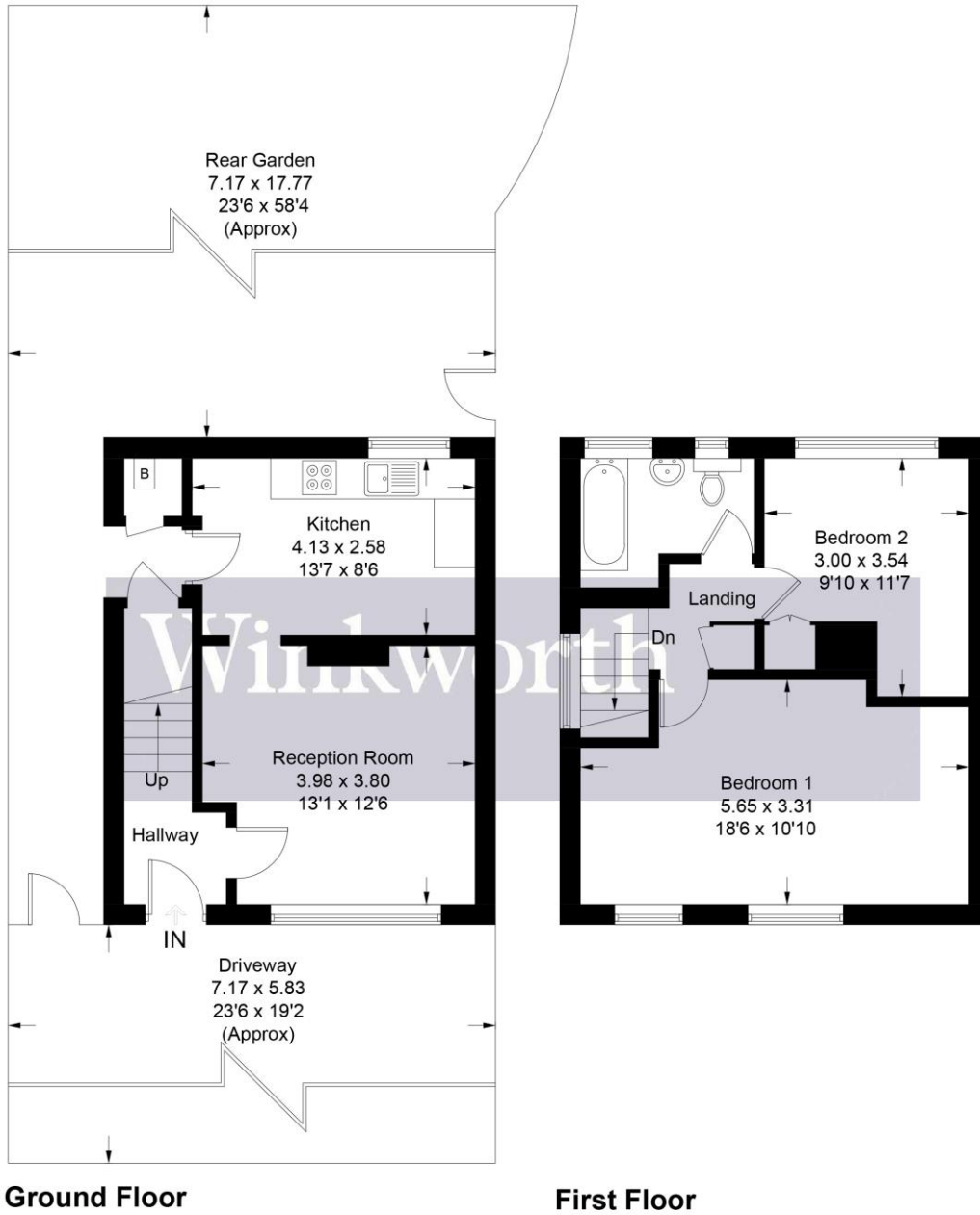

Illustration for identification purposes only, measurements are approximate, not to scale. Winkworth © 2023 (ID1009798)

This floorplan is for illustration purposes only and is not to scale. The position and size of doors, windows, appliances and other features are approximate.

Energy Efficiency Rating	
Current	Potential
<small>Very energy efficient - lower running costs</small>	
A (92-100)	84
B (81-91)	
C (69-80)	
D (55-68)	
E (39-54)	
F (21-38)	
G (1-20)	
<small>Not energy efficient - higher running costs</small>	
England, Scotland & Wales <small>EU Directive 2002/91/EC</small>	