



WEST ROAD, BERKSHIRE, RG40
£339,000 LEASEHOLD

Winkworth

WEST ROAD, BERKSHIRE, RG40

In a tranquil woodland setting alongside Downshire golf course, Badgerwood Park is a one of a kind park offering first-class modern living in an exclusive location close to Wokingham with leisure facilities and other amenities nearby.

This immaculately presented 2 bedroom park home offered to the market with no onward chain, comprises open plan kitchen/dining room comprehensively fitted with a full range of integrated appliances, living room with impressive vaulted ceilings and French doors to a secluded garden space, there are 2 double bedrooms with walk in wardrobe and en-suite shower room to the master and a further family bathroom. This wonderful park home also benefits from enough parking on the drive for two cars, a single garage, an artificially turfed garden with lighting and a storage shed.





Badgerswood

Approximate Gross Internal Area = 78.0 sq m / 839 sq ft

Garage = 16.6 sq m / 179 sq ft

Total = 94.6 sq m / 1018 sq ft

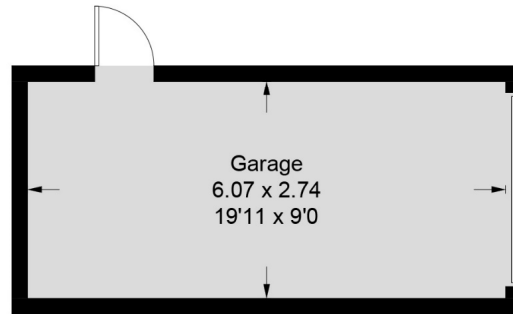

(Not Shown In Actual Location / Orientation)

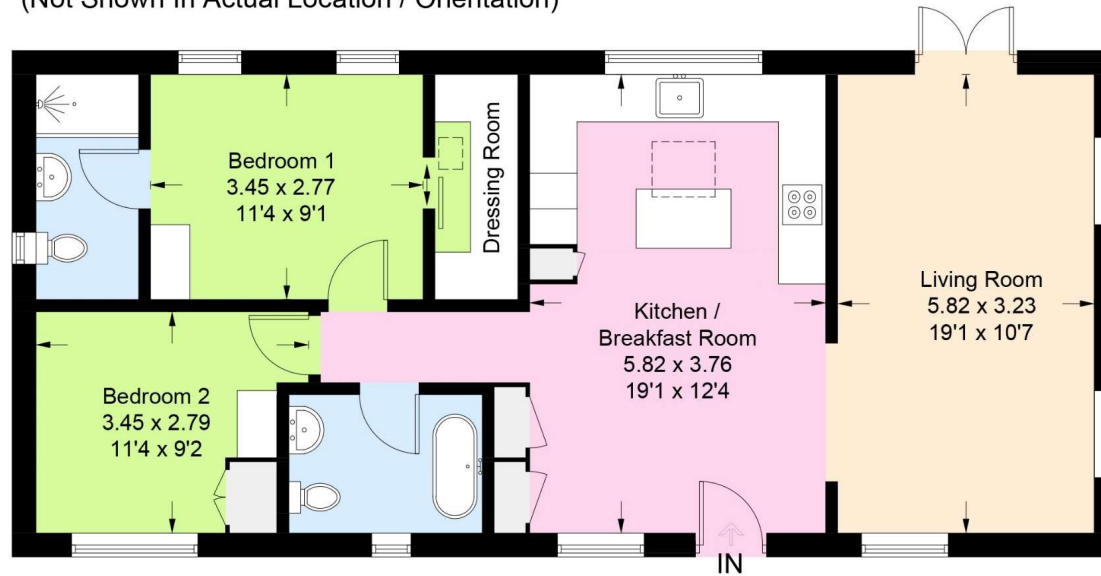

Ground Floor

Illustration for identification purposes only,
measurements are approximate, not to scale.