



GRANTHAM GREEN, HERTFORDSHIRE, WD6
£410,000 FREEHOLD

AN UNMODERNISED THREE BEDROOM FAMILY HOUSE IN SOUTH BOREHAMWOOD

Borehamwood | 020 8953 8899 | borehamwood@winkworth.co.uk



DESCRIPTION:

After being in the same family occupation for over fifty years, this unmodernised three bedroom house represents an almost unique opportunity to create your own bespoke family home.

Offered for sale chain free, the property measures in excess of 1000 square feet, is in need of complete refurbishment, which has been reflected in the price, and offers scope for extension subject to the usual planning consents.

Located in a quiet sought after turning on the South side of Borehamwood, several Ofsted rated "Good" and "Outstanding" Schools including Monksmead, Kenilworth and Yavneh are located nearby.

AT A GLANCE

- 3 Bedrooms
- Chain Free
- South Borehamwood
- Southerly Rear Garden
- 1024 Square Feet
- Scope To Extend (Stpp)





Winkworth



Winkworth



Winkworth

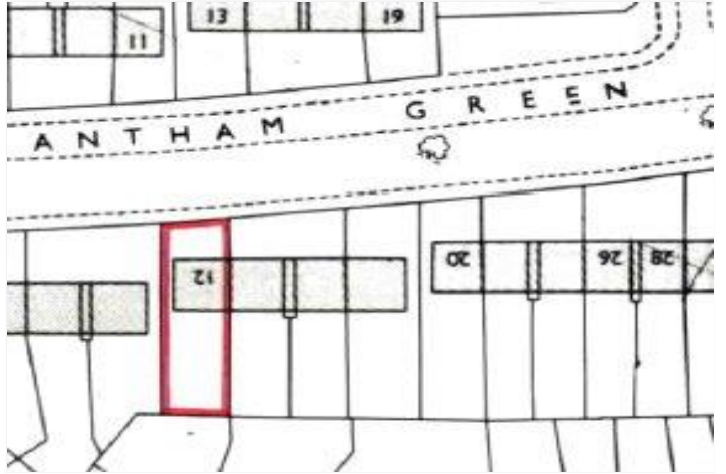

Winkworth

Approximate Gross Internal Area = 95.1 sq m / 1024 sq ft

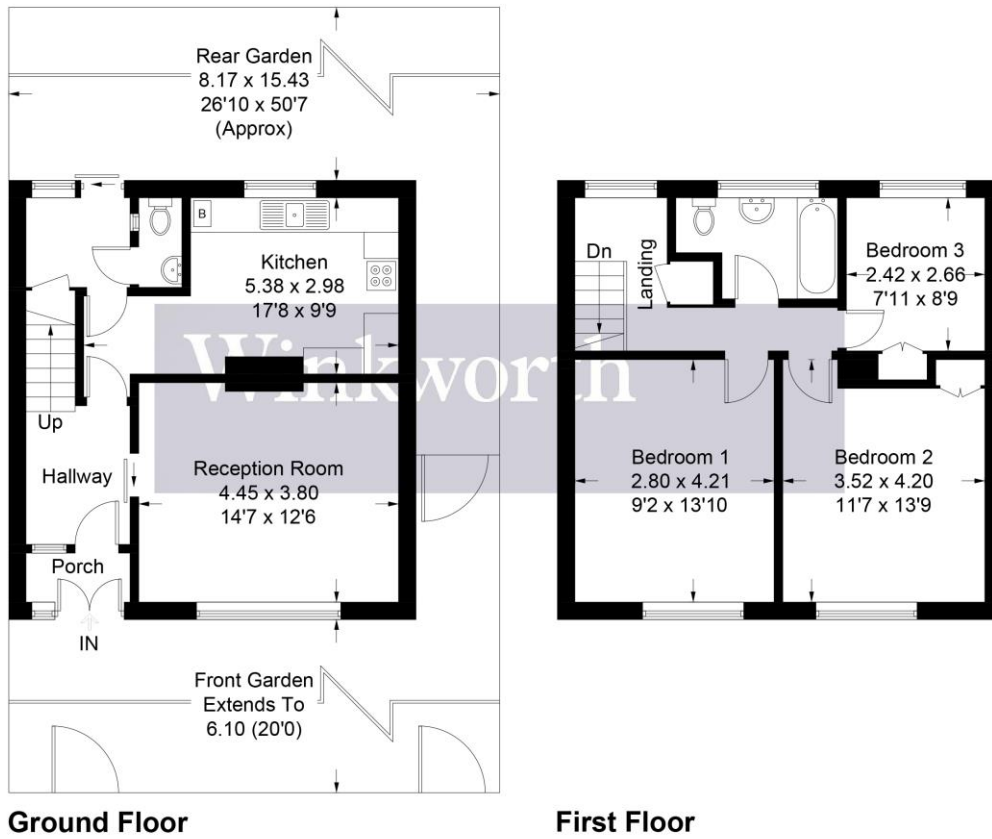

Illustration for identification purposes only, measurements are approximate, not to scale. Winkworth © 2023 (ID1027327)

This floorplan is for illustration purposes only and is not to scale. The position and size of doors, windows, appliances and other features are approximate.

