



Winkworth



Winkworth



Winkworth

BOREHAM HOLT, BOREHAMWOOD, HERTFORDSHIRE, WD6
£370,000 LEASEHOLD

A WELL PRESENTED TWO DOUBLE BEDROOM FIRST FLOOR APARTMENT

Borehamwood | 020 8953 8899 | borehamwood@winkworth.co.uk



Winkworth

DESCRIPTION:

Offered for sale with an unexpired lease length of in excess of 938 years is this bright and spacious two double bedroom first floor apartment offering well proportioned accommodation totalling approx. 700 square feet.

Discreetly positioned in a quiet cu de sac within walking distance of both Elstree Thameslink station and Shenley Road with its plethora of shops and restaurant the property would suit first time buyers, downsizers and investors alike.

AT A GLANCE

- 2 Bedrooms
- 731 Square Feet
- Communal Gardens
- Residents Parking
- Fitted Wardrobes
- Double Glazed
- 938 Year Lease
- Southerly Facing Reception



Winkworth



Winkworth



Approximate Gross Internal Area = 67.9 sq m / 731 sq ft

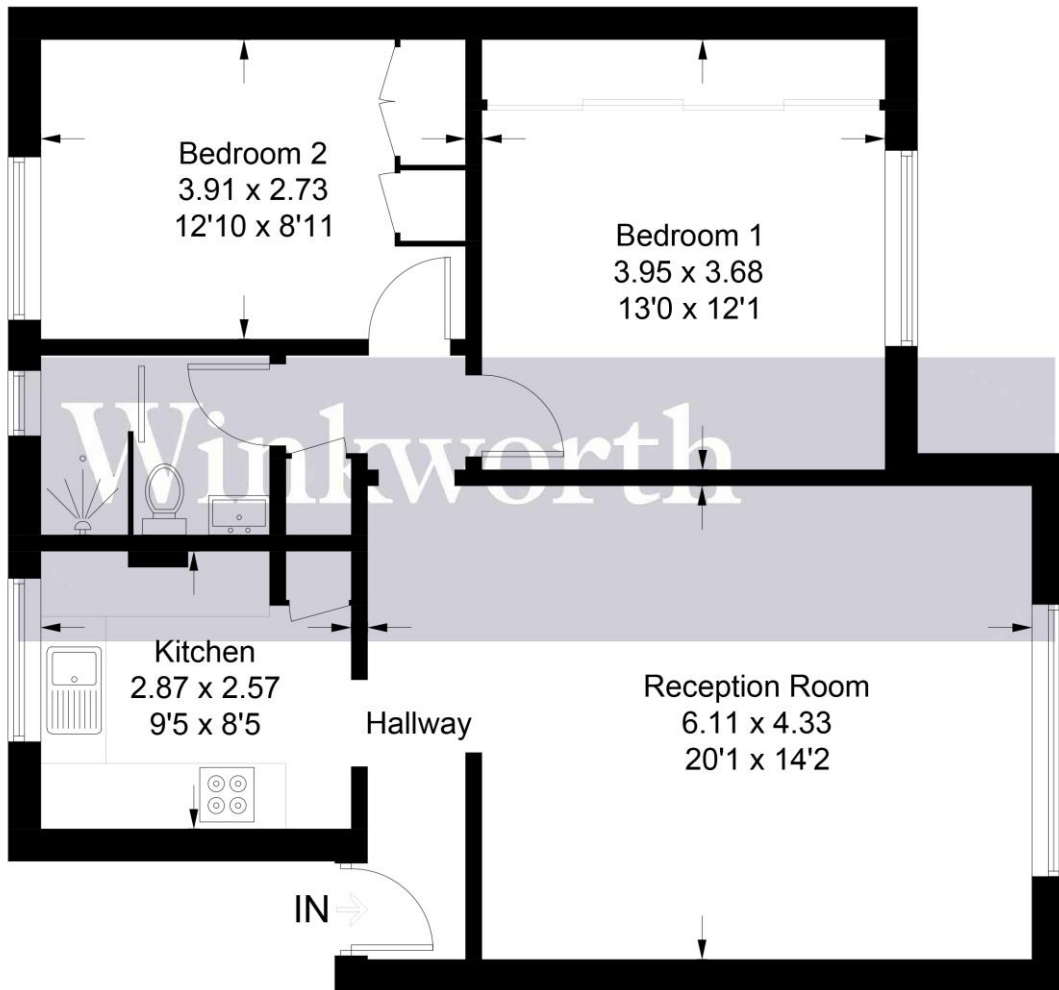

Illustration for identification purposes only, measurements are approximate, not to scale. Winkworth © 2023 (ID965108)

This floorplan is for illustration purposes only and is not to scale. The position and size of doors, windows, appliances and other features are approximate.

