



RUTHERFORD HOUSE, BRADY STREET, LONDON, E1
£300,000 LEASEHOLD

A SPACIOUS ONE BEDROOM FLAT SET IN A PLEASANT PURPOSE BUILT BLOCK WITH COMMUNAL GARDEN.

Shoreditch | 020 7749 7650 | shoreditch@winkworth.co.uk





DESCRIPTION:

A spacious, one double bedroom apartment set across the ground floor of this purpose-built block between Bethnal Green and Whitechapel. Standing at 591sqft, the property offers a bright, larger than average reception room which features two large windows and laminate wood flooring. The separate kitchen offers plenty of worktop space and storage while the good-sized master double bedroom benefits from dual-aspect windows and plentiful wardrobe space. The property is completed with ample storage space, family bathroom, communal garden and is also offered to the market on a chain free basis.

Brady Street is in an ideal location with an array of local amenities on Bethnal Green Road and Whitechapel Road as well the boutique shops, cafes, bars and restaurants on Brick Lane, Spitalfields Market, Redchurch Street and Shoreditch High Street. You have fantastic transport links with Bethnal Green and Shoreditch High Street overground stations as well as Bethnal Green, Whitechapel (Crossrail), Liverpool Street, Aldgate and Aldgate East underground stations all close by.

Winkworth



Winkworth

Rutherford House, Brady Street, E1

Approx. Gross Internal Floor Area 595 sq. ft / 55.25 sq. m

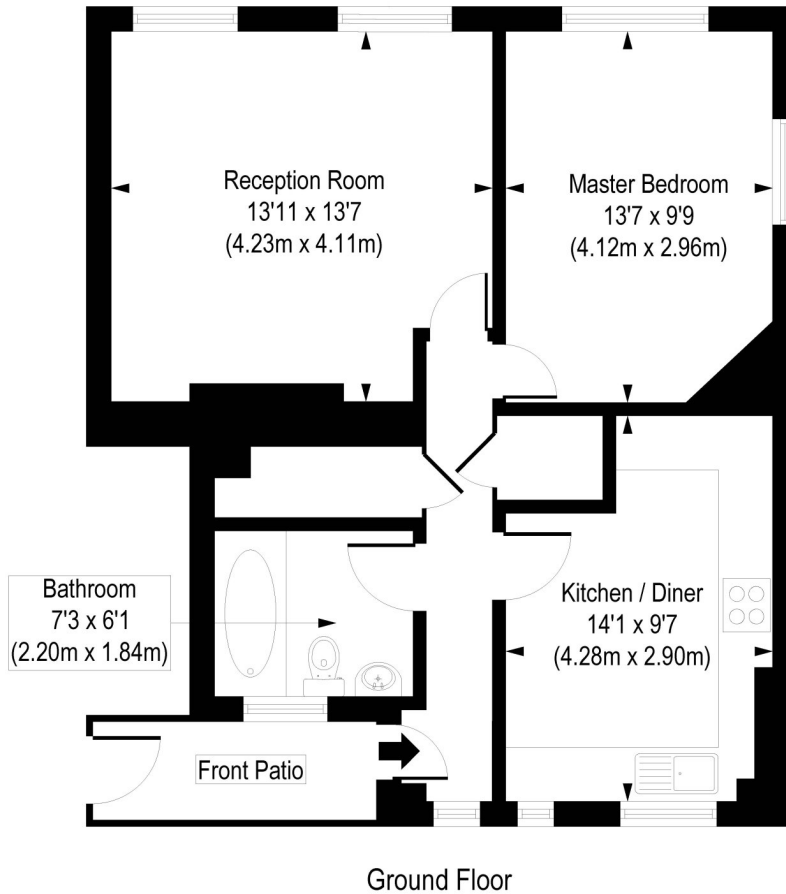

COMPLIANT WITH RICS CODE OF MEASURING PRACTICE. Floorplan is for illustrative purposes only and is not to scale. Every attempt has been made to ensure the accuracy of the floorplan shown, however all measurements, fixtures, fittings and data shown are an approximate interpretation for illustrative purposes only. Liability for errors, omissions or mis-statement through negligence or otherwise is hereby excluded.

This floorplan is for illustration purposes only and is not to scale. The position and size of doors, windows, appliances and other features are approximate.

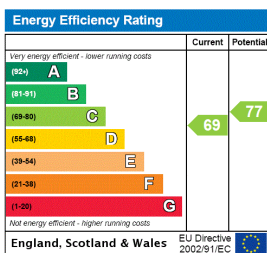

Shoreditch | 020 7749 7650 | shoreditch@winkworth.co.uk



winkworth.co.uk

See things differently

Winkworth wishes to inform prospective buyers and tenants that these particulars are a guide and act as information only. All our details are given in good faith and believed to be correct at the time of printing but they don't form part of an offer or contract. No Winkworth employee has authority to make or give any representation or warranty in relation to this property. All fixtures and fittings, whether fitted or not are deemed removable by the vendor unless stated otherwise and room sizes are measured between internal wall surfaces, including furnishings.