



JOHN SPENCER SQUARE, ISLINGTON, LONDON, N1
£800,000 SHARE OF FREEHOLD

A CHARMING TWO BEDROOM FLAT SET OVER
THE SECOND FLOOR OF THIS TRULY WONDERFUL
NEO-GEORGIAN BLOCK IN CANONBURY

Islington | 0207 354 2480 | islington@winkworth.co.uk

Winkworth

winkworth.co.uk

See things differently



DESCRIPTION:

Set amongst the most desirable roads in Canonbury is this exquisite two bedroom flat in John Spencer Square. The property offers the most wonderful proportions and light filled rooms and is located on the second floor so provides excellent views over the pristine residents garden to the rear. Accommodation includes two double bedrooms, separate kitchen, a large reception room and family bathroom. The property further benefits from a share of freehold and is offered to the market chain free.

John Spencer Square is located in the much sought after area of Canonbury, tucked away off St Paul's Road and moments from Upper Street. Fantastic shopping amenities are provided close by with a selection of independent shops and boutiques as well as Waitrose on Highbury corner and high street stores at Angel. Transport links are best served by Highbury & Islington station which is less than a 5 minute walk away, offering Victoria, London over ground and First Capital Connect services whilst further over ground services are also found at Canonbury station. Angel underground station is also a short distance away and a variety of bus links can be found on Highbury corner providing easy access to the City and West End.

Winkworth



Winkworth

John Spencer Square, N1

Approx. Gross Internal Floor Area 816 sq. ft / 75.81 sq. m

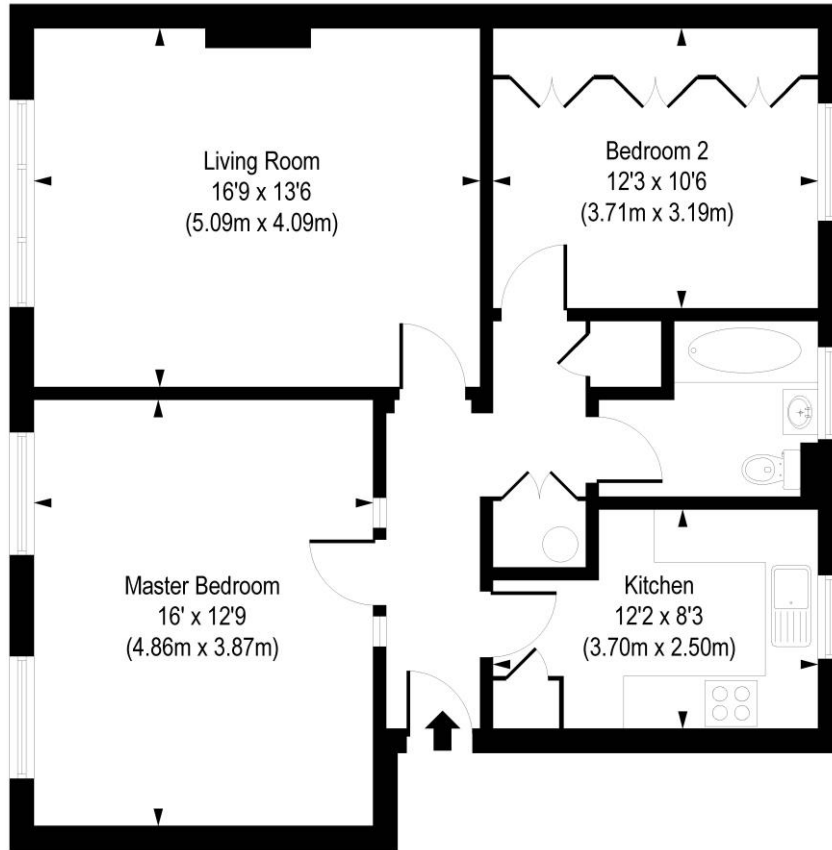
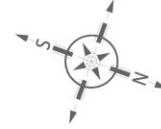

Second Floor

COMPLIANT WITH RICS CODE OF MEASURING PRACTICE. Floorplan is for illustrative purposes only and is not to scale. Every attempt has been made to ensure the accuracy of the floorplan shown, however all measurements, fixtures, fittings and data shown are an approximate interpretation for illustrative purposes only. Liability for errors, omissions or mis-statement through negligence or otherwise is hereby excluded.

This floorplan is for illustration purposes only and is not to scale. The position and size of doors, windows, appliances and other features are approximate.

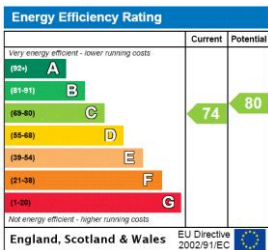

Islington | 0207 354 2480 | islington@winkworth.co.uk



winkworth.co.uk

See things differently

Winkworth wishes to inform prospective buyers and tenants that these particulars are a guide and act as information only. All our details are given in good faith and believed to be correct at the time of printing but they don't form part of an offer or contract. No Winkworth employee has authority to make or give any representation or warranty in relation to this property. All fixtures and fittings, whether fitted or not are deemed removable by the vendor unless stated otherwise and room sizes are measured between internal wall surfaces, including furnishings.